

# Preparing Vaccine Storage Units

Prepare vaccine refrigerators and freezers to maintain stable temperatures. Stabilize temperatures before storing vaccines. The concepts are identical for both refrigerators and freezers.

## 1. Protect the power supply.

### DO

- Plug each storage unit into its dedicated wall outlet.
- Secure the plug with a guard or cover and post “Do Not Unplug” signs.
- Label fuses and circuit breakers so the Vaccine Coordinator is alerted if power goes off.

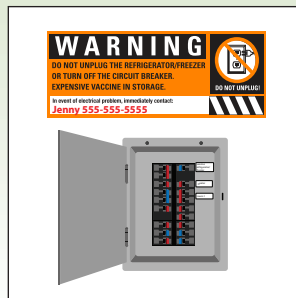

### DO NOT USE

- Multi-outlet power strips or extension cords
- Outlets with GFI circuit switches (they have red reset buttons)
- Outlets that are controlled by wall switches

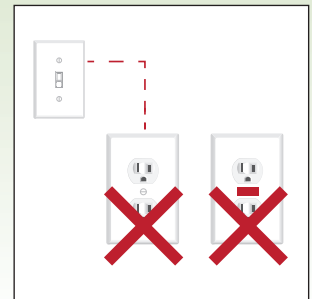
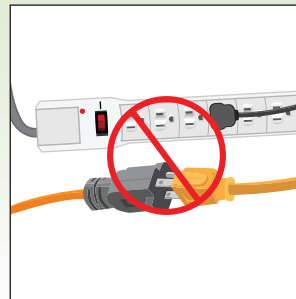

## 2. Add plenty of water bottles (refrigerators) or cold packs (freezers only) in unstable areas:

- On the top shelf (don't block air vents)
- On the unit's floor (for household stand-alone units, remove drawers and bins)
- In any door shelves

**Tip:** Add them along the back wall to prevent vaccines from touching the wall.

### Refrigerators

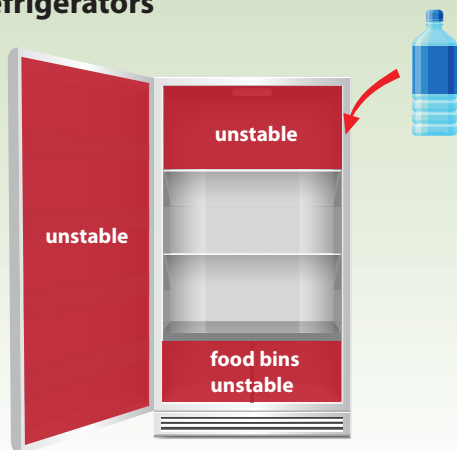

Household-grade

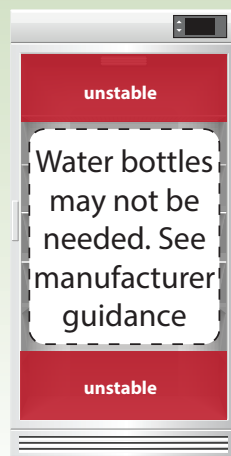

Pharmaceutical-grade

### Chest freezer

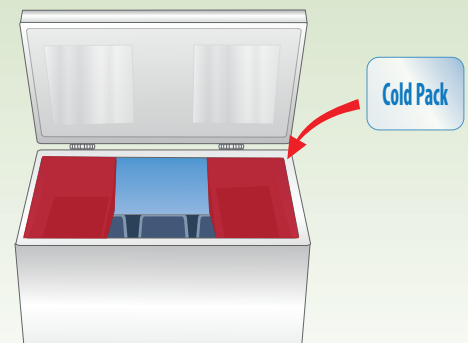

# Preparing Vaccine Storage Units

## 3. Set up a data logger for each storage unit.

- Place the buffered probe in the center of the storage unit next to vaccines.
- Place or mount the digital display so temperatures can be read without opening the storage unit door.
- Thread the probe's cable through the side of the door and attach it to the digital display.
- Store your backup device's buffered probe in the vaccine refrigerator.



## 4. Ensure the data logger is recording.

**Tip:** Some devices might display "REC" or "RECORDING."



## 5. Set storage unit temperatures.

### For refrigerators.

Set thermostat to 40°F (4°C). If it has a dial, adjust the temperature dial as needed.

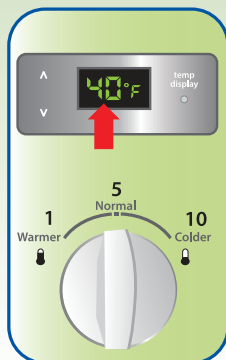

### For freezers.

Set thermostat to below 0°F (-18°C). If it has a dial, set it to the coldest.

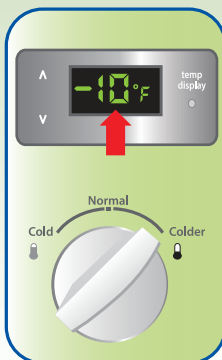

## 6. Post temperatures logs.

### Post temperature logs on the refrigerator and freezer doors.

Once temperatures have stabilized, record CURRENT, MIN, and MAX temperatures on the logs twice daily.

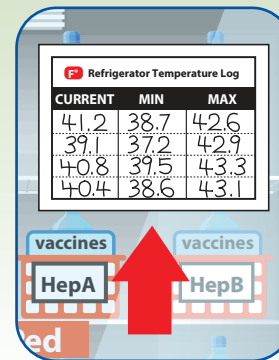
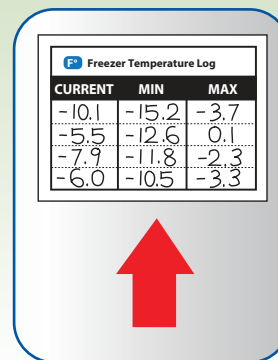

## While Waiting for Temperatures to Stabilize

7. Configure data logger settings using the "Data Logger Setup & Use" job aid.

8. Set up storage units using the "Setting Up Vaccine Storage Units" job aid.